



# ViewSpace

## Video Kiosk and Interactives Setup Guides

*Last updated: October, 2023*

### Contents

Contents.....1

Introducing ViewSpace's Content Types.....2

Setting up ViewSpace Video Collections as a Kiosk (Exhibit) .....3

    A. System Requirements .....3

    B. Receiving an Invitation.....3

    C. Preparing for Installation .....3

    D. Signing Up .....3

    E. Opening ViewSpace.org.....5

    F. Controlling the Video.....5

    G. Auto-play for Public Display.....6

    H. Enabling Sound in Auto-play.....10

Installing the ViewSpace Interactives Web App .....13

    A. Desktop Computer (using Google Chrome).....13

    B. iOS Mobile Device (using Safari) .....14

    C. Android Mobile Device (using Google Chrome).....17

Support and Contact Information.....22

## Introducing ViewSpace's Content Types

In order to navigate this guide, you must first understand the types of content ViewSpace provides, including:

ViewSpace Content	Description	How to get started
<b>Videos</b>	ViewSpace currently offers hundreds of videos covering a wide range of Earth and space science topics, ranging from the "Life and Death of Stars" to "Extreme physics and phenomena."	To <b>view a single video</b> on a particular topic, use the main navigation on ViewSpace.org to go to Videos, and then Video Library ( <a href="https://viewspace.org/video_library">https://viewspace.org/video_library</a> ). From there, you can use the <b>Sort</b> feature to filter videos alphabetically, by length, or by publication date, the <b>Search Topics</b> bar, or the <b>Popular Topics</b> drop-down menu to filter videos by science topics covered.
<b>Video Collections</b>	Libraries, museums, science centers, and other informal learning venues can <b>set up a monitor</b> to play a preset Earth, Space, or Earth and Space Collection of videos (collectively referred to as ViewSpace Collections) for their visitors to engage them in learning about the wonders of our universe.	Review the " <a href="#">Setting up ViewSpace Video Collections as a Kiosk (Exhibit)</a> " section of this setup guide.
<b>Interactives</b>	ViewSpace interactives enable users to explore NASA data in greater detail and at their own pace using touchscreens or computer controls, by allowing them to fade between and compare multiple images or parts of the same image. Interactives lead users through scientific stories by illustrating how objects change over time, are positioned in relation to one another, and/or how observing them in different wavelengths of light reveals unique details and phenomena.	To explore <b>individual ViewSpace interactives</b> , on the main navigation bar, go to Interactives, and then <b>About the Interactives</b> ( <a href="https://viewspace.org/interactives/unveiling_invisible_universe">https://viewspace.org/interactives/unveiling_invisible_universe</a> ). Scroll down to the <b>Start Exploring</b> section to browse interactives by topic.
<b>Interactives Web App</b>	ViewSpace's free Interactives Web App provides direct access to the complete library of ViewSpace interactives from a mobile device's home screen or a computer desktop, and can be locked to prevent users from navigating away from the library to access other sites, apps, or functionalities. This makes the Web App ideal for use as an interactive kiosk or during informal education programs and activities.	Review the " <a href="#">Installing the ViewSpace Interactives Web App</a> " section in this guide for instructions detailing how to download and secure the web app for public display on desktop and mobile devices.

## Setting up ViewSpace Video Collections as a Kiosk (Exhibit)

### A. System Requirements

To display ViewSpace Collections properly, make sure you have all of the following:

- An internet-connected device (e.g., a tablet, desktop or laptop computer, etc.) to display videos
- Reliable internet access that supports streaming video
- A modern web browser (e.g., Google Chrome, Firefox, Microsoft Edge, or Safari)  
**Note:** Chrome is best suited to support Kiosk Mode (see Section G below)
- **Optional:** An external display (e.g., monitor or projector) to showcase ViewSpace videos on a larger screen while securing the internet-connected device streaming the videos

### B. Receiving an Invitation

To access the ViewSpace Collections, you will need to be invited into the system after requesting an account. The invitation will arrive in the form of an e-mail from ViewSpace Support ([support@viewspace.org](mailto:support@viewspace.org)).

- If you haven't already, go to **Videos**, then **Video Collections** (<https://viewspace.org/playlists/featured>) and click on **Request Account**. From there, you'll be asked to enter your Contact Name and Title, as well as your Organization Name, Email, Zip Code, and Type (e.g., museum, science center, library, etc.). Once you click **Submit Account Request**, you should hear back from the team within seven business days.
- If you are expecting an e-mail but have not yet received it, check your junk or spam folders.
- If you still have not been sent an invitation after seven business days, please contact ViewSpace Support ([support@viewspace.org](mailto:support@viewspace.org)).

### C. Preparing for Installation

- Make sure the operating system of the computer, tablet, or other device you plan to use is up to date.
- Place your system in a location where you will be comfortable working on it.
- Make sure you have reliable internet access.
- Access your e-mail invitation from ViewSpace Support.

### D. Signing Up

1. Open the **Accept Invitation link** in the e-mail from ViewSpace Support. This will take you to the Account Setup page.
2. **Register** by creating a password of your choice.

**Note:** The e-mail shown on the Account Setup page is the e-mail that your invitation was sent to. If you want to register under a different e-mail, please contact ViewSpace Support ([support@viewspace.org](mailto:support@viewspace.org)).

### 3. Complete your **User Profile**.

**Note:** If not all required fields are completed, you will be prompted to fill them in. Don't forget to read and accept the [terms and conditions](#).

- Once you have submitted the form, your name should appear at the top of the screen. You are now free to use ViewSpace with your new username and password.

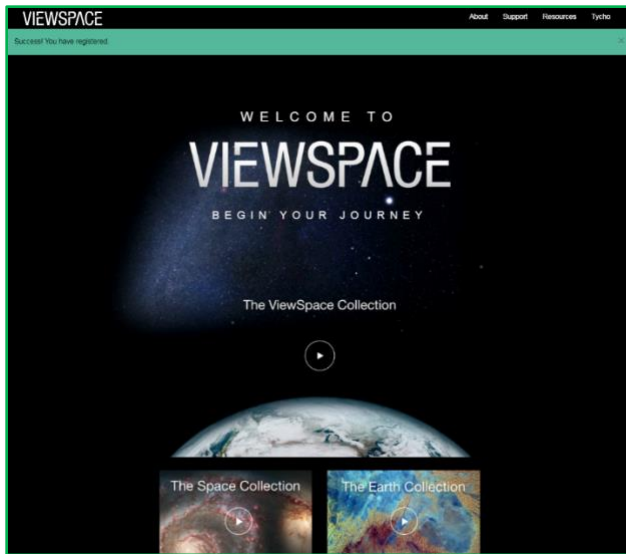

### E. Opening ViewSpace.org

Once you have registered, you can access the ViewSpace Collections via any internet-connected device.

1. Navigate to <https://viewspace.org>.
2. Enter your **username** and **password**.
3. Choose from one of three playlists:
  - **The ViewSpace Collection** plays all Earth and Space videos
  - **The Space Collection** plays videos focused on the Solar System, galaxy, and universe beyond Earth
  - **The Earth Collection** plays videos focused on Earth

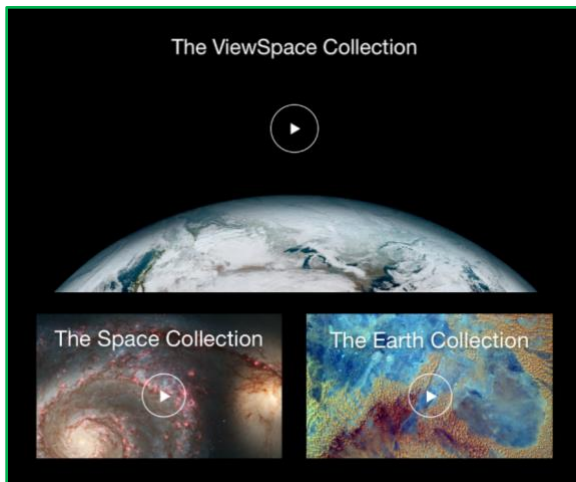

### F. Controlling the Video

Once you have signed up and logged in to ViewSpace, you have some control over the video while it is playing, as indicated in the following table.

To	Press
Pause/play	Left click on your mouse or touchpad

Skip to next video	Right arrow →
Toggle between full-screen and windowed view	f
Toggle mute on and off	m
Show Help	?

To view specific videos, exit the Collections and go to the **Video Library**.

## G. Auto-play for Public Display

You can set up ViewSpace to play automatically (Kiosk Mode) after restarting the computer, without logging in. This allows you to run ViewSpace as seamlessly as possible, without training many additional staff.

**Note:** The following instructions describe how to set up Kiosk Mode using Google Chrome on a Windows computer; however, ViewSpace may be used with many different types of hardware and software. Currently, we offer user support in Google Chrome, although users have found success using other web browsers, devices, and setups.

1. Set up Google Chrome to start automatically.
  - Change your settings so that Google Chrome will start automatically after the computer is rebooted. (You may need to get assistance from your IT specialist.) We have not included instructions here because the procedure differs from system to system.
  - **Note:** It is ok to skip this step altogether, or skip it for now and complete it later. If you do not perform this step, ViewSpace will still work, but you will need to restart Chrome every time the computer is restarted.

2. Create a Kiosk Persona.

Using a Kiosk Persona allows you to display ViewSpace without revealing any personal or institutional data.

- a. Open Google Chrome and click on your **Profile** icon at the top right.
- b. Click on **Add** to set up a new Chrome profile.

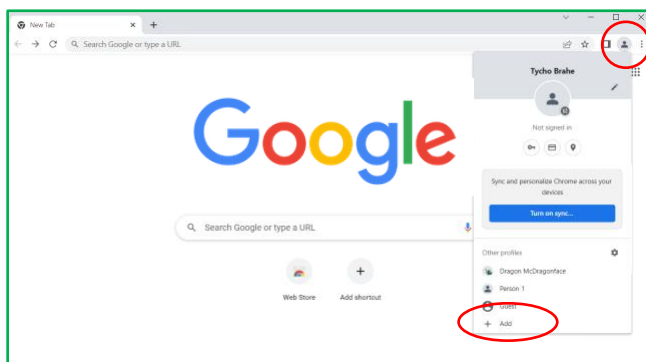

- c. Click on **Continue without an account**.

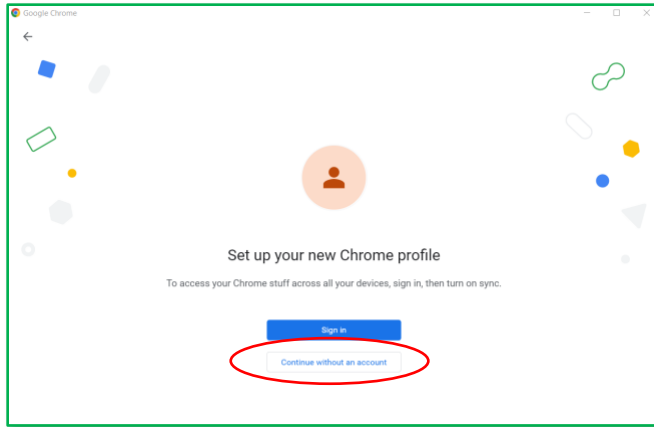

d. Customize your Chrome profile.

- 1) Give the new user a name.
- 2) Pick an avatar.
- 3) Choose a theme.
- 4) Click **Create a desktop shortcut for the user.**
- 5) Click **Done.**

You should now have a Chrome shortcut with the new username on your desktop.

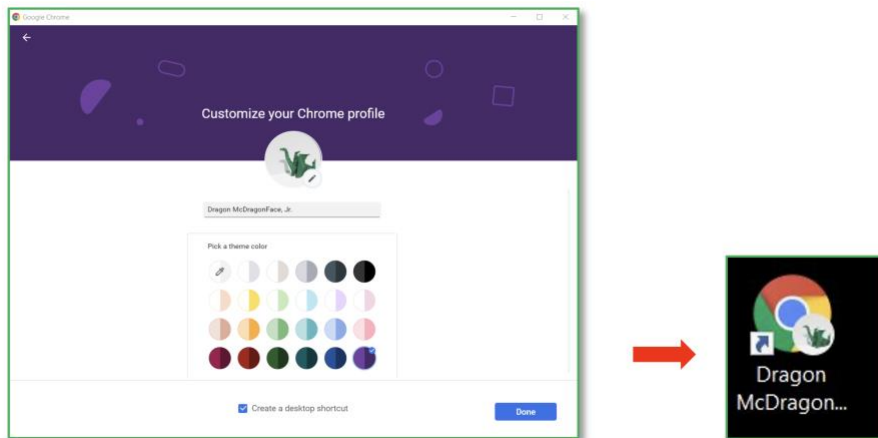

3. Retrieve your auto-play URL.

- a. Log in to **ViewSpace.org** (<https://viewspace.org>) with your username and password.
- b. Go to your **User Profile** by clicking on your name (usually in the top right corner) or going to <https://viewspace.org/profile>.

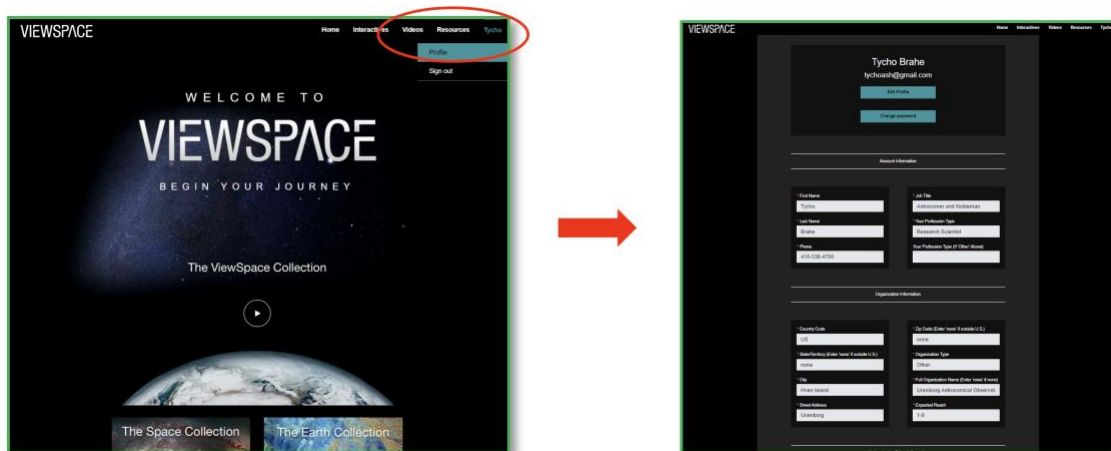

- c. Scroll down to the bottom of the profile page. Here you will find your **auto-login URLs**.

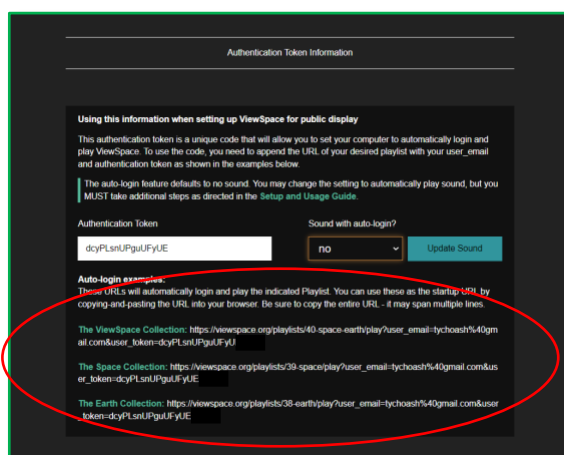

- d. Copy the **auto-login URL** of the video collection that you want to view (ViewSpace, Space, or Earth Collection). **Note:** This URL includes your authentication token and is unique to you.
- e. Keep the window open for easy access in the next step.
4. Set up your Kiosk Persona to play ViewSpace automatically.
- Right click on the **Shortcut** for your new Kiosk Persona, which should be on your desktop (not on the taskbar), and select **Properties**.



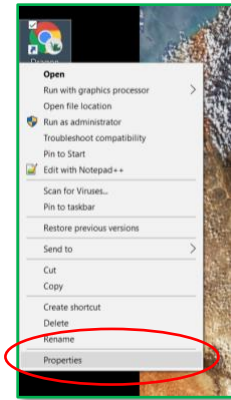

b. In the Shortcut menu:

- 1) Select **Target**.
- 2) Add “ --kiosk” (space hyphen hyphen kiosk, without the quotation marks) to the end of the Target text.
- 3) Then add the playlist **auto-login URL** that you copied from your profile page (see [previous step](#)): “ [playlist name]” (space space playlist name, without the quotation marks) after “kiosk”.
- 4) Click **Apply**.

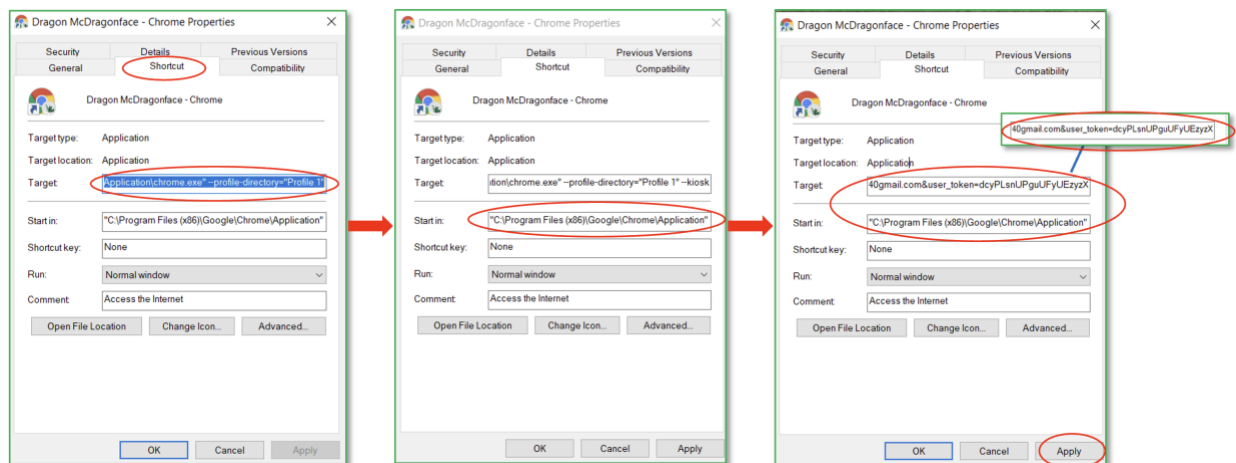

c. Click on the **Shortcut** to your Kiosk Persona to test it. If the settings are correct, your preferred playlist should now open in the Kiosk Persona user account in full-screen mode.

- On the first launch, you may need to sign in. To avoid having to enter your username and password each time, choose **Save** when prompted to save your password.
- **Note:** This will not open in full screen if you already have Google Chrome open. But once you close your other Google Chrome windows and reopen, it should open in full-screen.

**Note:** This setup can enable visitors to access your computer if the keyboard or touchscreen is also **accessible**: Exiting ViewSpace (Alt-F4) will give a guest the opportunity to access your entire device. To increase security, we recommend keeping the keyboard or touchscreen in a location that is inaccessible to the public. For example, a librarian or museum educator may choose to place a desktop computer

streaming ViewSpace in a locked cabinet, at a staffed desk, or in a room inaccessible to visitors near the screen displaying the videos.

## H. Enabling Sound in Auto-play

Every ViewSpace video is produced with background music. However, a 2019 update of Google Chrome prevents advertisements with sound from playing automatically. Because this functionality affects all videos, including those on ViewSpace, the default for ViewSpace auto-play is now set for no sound.

**To enable video sound during auto-play:**

1. On your profile page ([viewspace.org/profile](https://viewspace.org/profile)), scroll down and set “Sound with auto-login?” to **yes** and click on **Update Sound**.

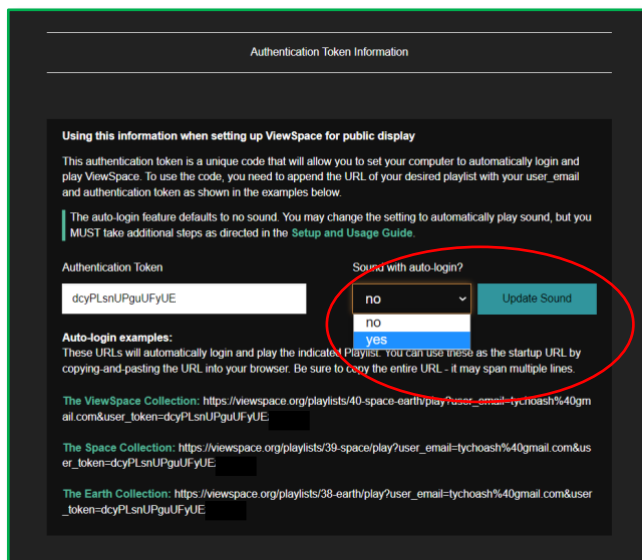

Authentication Token Information

Using this information when setting up ViewSpace for public display

This authentication token is a unique code that will allow you to set your computer to automatically login and play ViewSpace. To use the code, you need to append the URL of your desired playlist with your user\_email and authentication token as shown in the examples below.

The auto-login feature defaults to no sound. You may change the setting to automatically play sound, but you MUST take additional steps as directed in the [Setup and Usage Guide](#).

Authentication Token: dcyPLsnUPguUFyUE

Sound with auto-login?

no

no

yes

Update Sound

Auto-login examples:

These URLs will automatically login and play the indicated Playlist. You can use these as the startup URL by copying and pasting the URL into your browser. Be sure to copy the entire URL - it may span multiple lines.

The ViewSpace Collection: [https://viewspace.org/playlists/40-space-earth/play?user\\_email=tychoash%40gmail.com&user\\_token=dcyPLsnUPguUFyUE](https://viewspace.org/playlists/40-space-earth/play?user_email=tychoash%40gmail.com&user_token=dcyPLsnUPguUFyUE)

The Space Collection: [https://viewspace.org/playlists/39-space/play?user\\_email=tychoash%40gmail.com&user\\_token=dcyPLsnUPguUFyUE](https://viewspace.org/playlists/39-space/play?user_email=tychoash%40gmail.com&user_token=dcyPLsnUPguUFyUE)

The Earth Collection: [https://viewspace.org/playlists/38-earth/play?user\\_email=tychoash%40gmail.com&user\\_token=dcyPLsnUPguUFyUE](https://viewspace.org/playlists/38-earth/play?user_email=tychoash%40gmail.com&user_token=dcyPLsnUPguUFyUE)

2. You'll get a pop-up reminder to view the Setup Guide. Click **OK**.

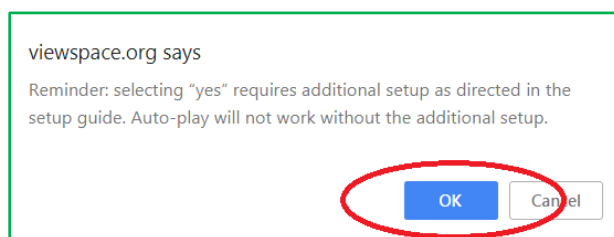

viewspace.org says

Reminder: selecting "yes" requires additional setup as directed in the setup guide. Auto-play will not work without the additional setup.

OK

Cancel

3. Open the Chrome shortcut to the profile you set up for Kiosk Mode, and go to **Settings**.

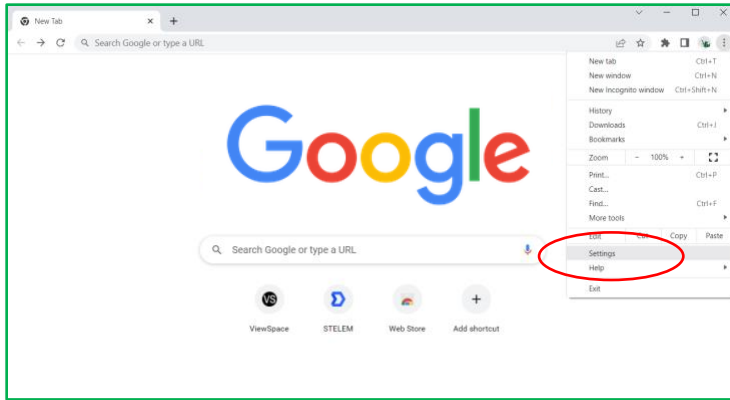

4. Click on **Privacy and Security**.

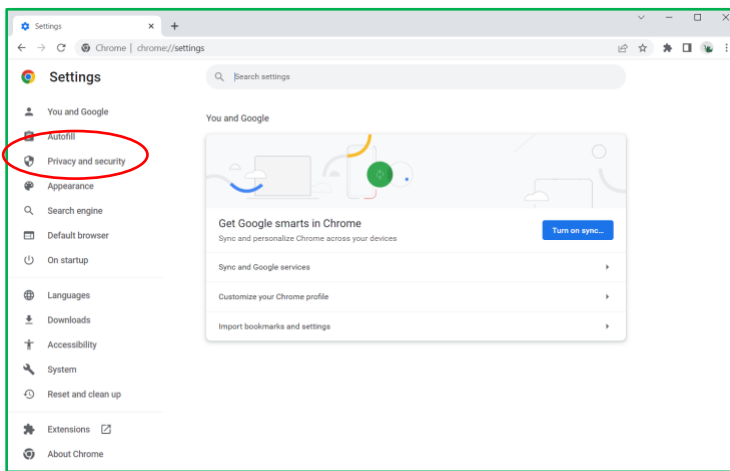

5. Select **Site Settings**.

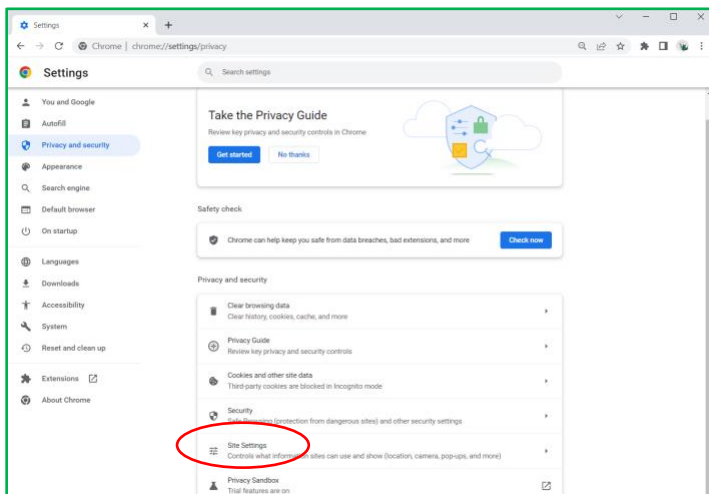

6. Click on the **Sound** option. (You may need to expand **Additional Content Settings**.)

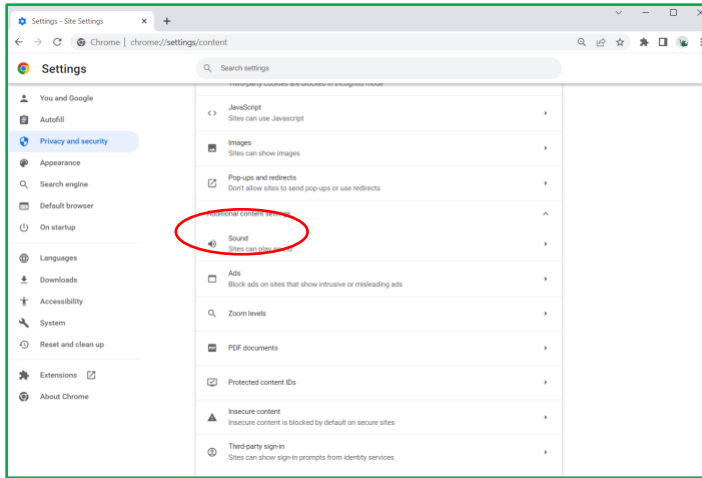

7. Click on **Sites can play sound**.

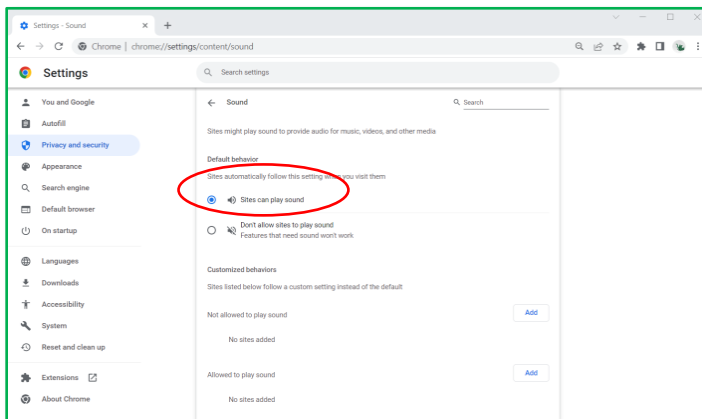

8. Add **ViewSpace.org** as one of the allowed websites.

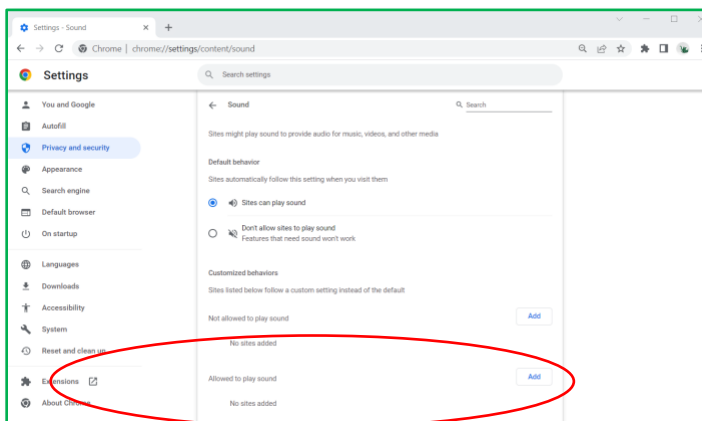

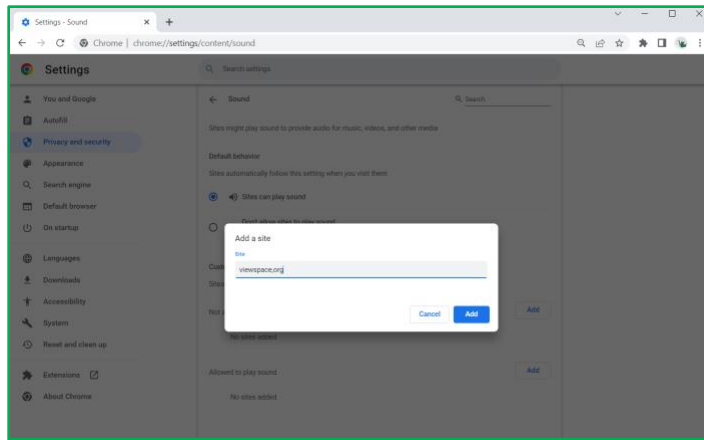

9. Test the new setup by clicking on the **Shortcut** you created earlier to start ViewSpace in kiosk mode. If ViewSpace starts with sound, success! If not, please review the steps listed above.

## Installing the ViewSpace Interactives Web App

ViewSpace's **free** Interactives Web App (hereafter referred to as "Web App") provides direct access to the complete library of ViewSpace interactives from a mobile device's home screen or a computer desktop, and can be locked using Guided Access (on iOS devices) or pinning (on Android devices) to prevent users from navigating away from the library to access other sites, apps, or functionalities, making the Web App ideal for use as an interactive kiosk or during informal education programs.

**Note:** The following instructions describe how to install the Web App using Google Chrome on a desktop computer (either Microsoft or iOS/Apple), Safari on an Apple (iOS) device, and Google Chrome on an Android device, respectively. However, ViewSpace may be compatible with many different types of hardware and software.

### A. Desktop Computer (using Google Chrome)

#### Installing the Web App on a Desktop

**Note:** The images in this section illustrate the steps for installing the Web App using Google Chrome on an iOS (Apple) desktop computer, however you can follow similar steps using Microsoft Edge.

1. Open Google Chrome and go to ViewSpace.org. At the top right of the address bar, click the **Install ViewSpace Interactives** button.

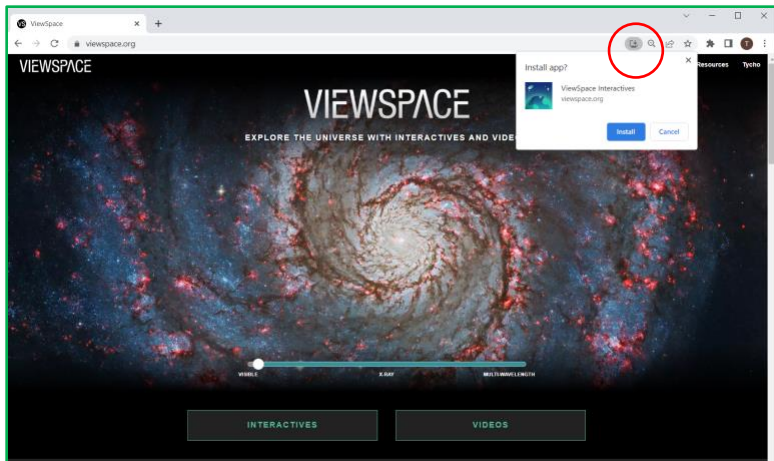

## 2. Click on **Install**.

- A shortcut to the Web App will appear on your desktop or in your Launchpad (Mac).

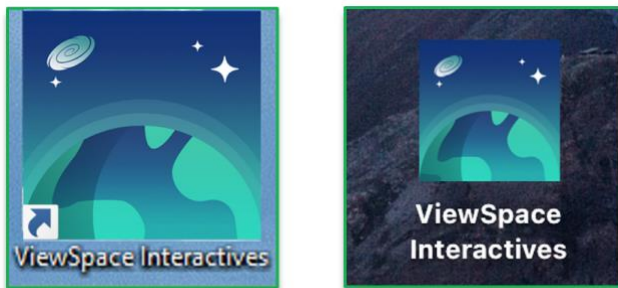

- In addition, the next time you access the website, the install button will be replaced with a link to open the Web App.

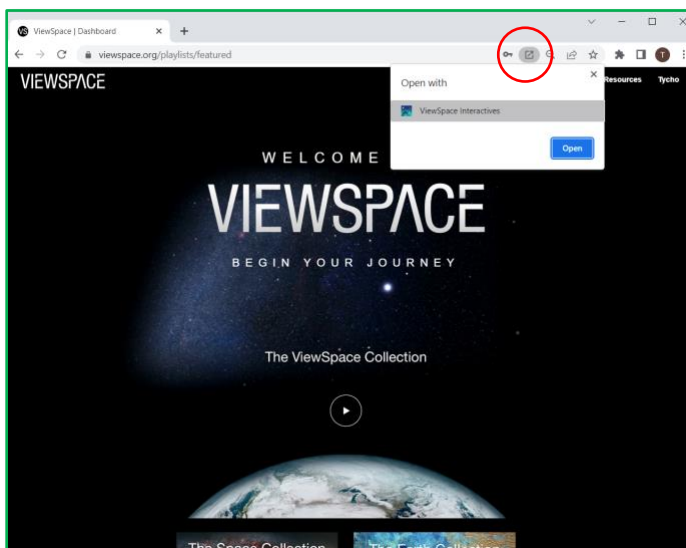

## B. iOS Mobile Device (using Safari)

## Installing the Web App on an iOS Mobile Device

1. Open ViewSpace.org in Safari.
2. Click on the **share** icon, either on the top of bottom of the screen (this resembles a box with an arrow emerging from the top).

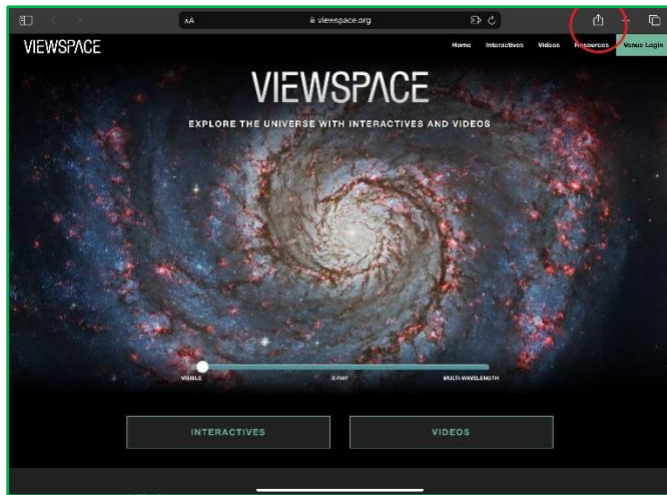

3. Choose the **Add to Home Screen** option.

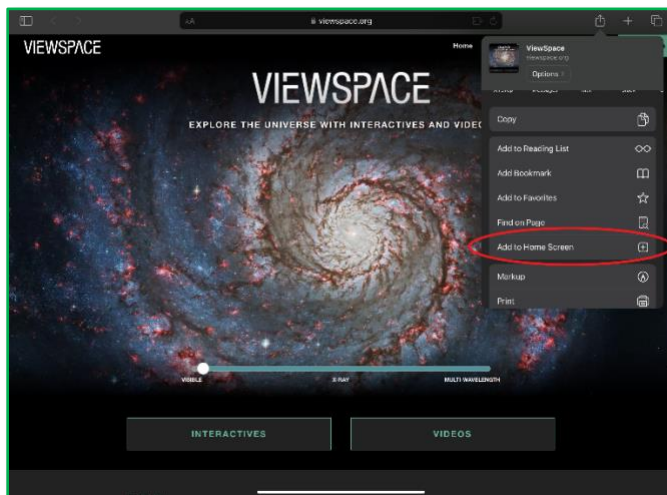

- Click **Add to Home Screen**. This will install the Web App to the device.

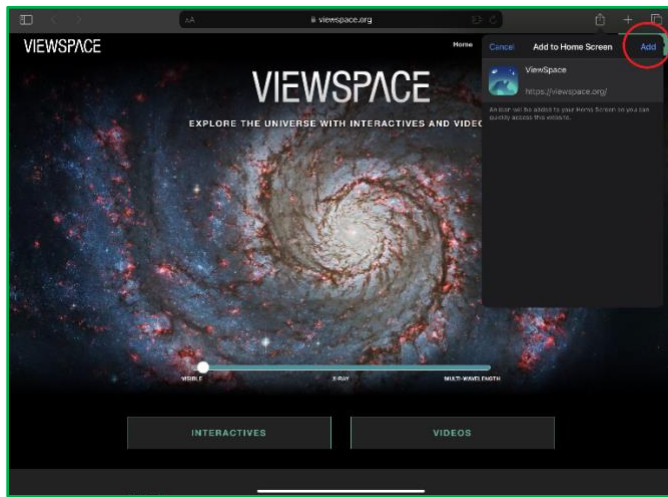

- The ViewSpace Web App icon should now appear on your home or app screen.

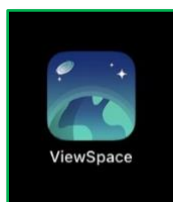

## Securing the Web App on an iOS Mobile Device

- To prevent users from navigating away from the Web App to other websites or applications when using your iOS device as an interactive kiosk or during programs, you can set up Guided Access. To do this, first open the **Accessibility** menu within **Settings**, and click on **Guided Access**.

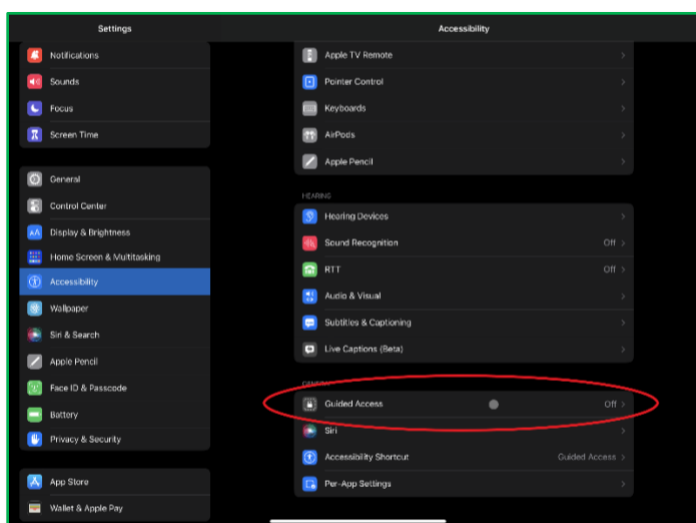

- Toggle on **Guided Access** and follow the instructions to set up a passcode. **Note:** Guided Access will apply to all of your apps, not just ViewSpace.



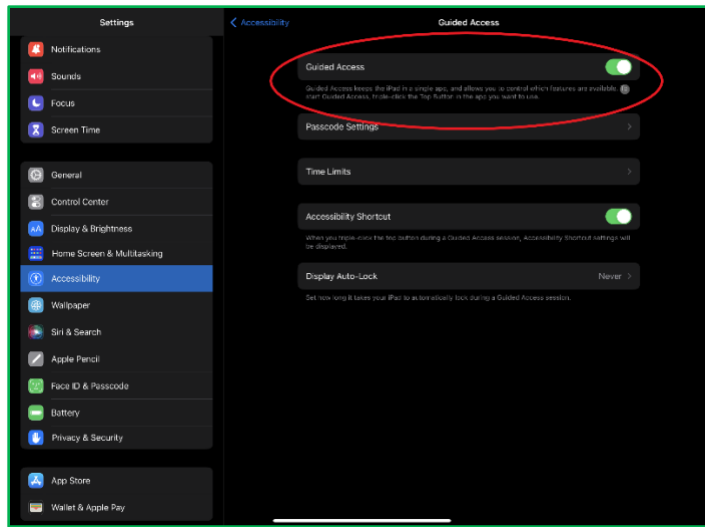

3. **To turn off Guided Access** on an iOS device, you can do any of the following:
  - a. Triple-click the side button or Home button on your device, and then enter the **Guided Access passcode** you created (see previous step).
  - b. On an iPad or iPhone with **Face ID** turned on, you can double-click the side button on your device, then use your Face ID to unlock the screen.
  - c. On an iPhone or iPad with **Touch ID** turned on, you can double-click the Home button, then unlock the screen with your fingerprint using Touch ID.

### C. Android Mobile Device (using Google Chrome)

**Note:** The following instructions detail how to install the Web App on a Samsung Galaxy Tab S8 (hereafter referred to as “Samsung tablet”) using Google Chrome, however it may also work using other browsers. Please note that not all Android devices may follow the same installation process.

#### Installing the Web App on an Android Mobile Device

1. Open **ViewSpace.org** in Google Chrome.
2. Click on the three dots in the upper navigation bar. From the resulting drop-down menu, select **Install app**.

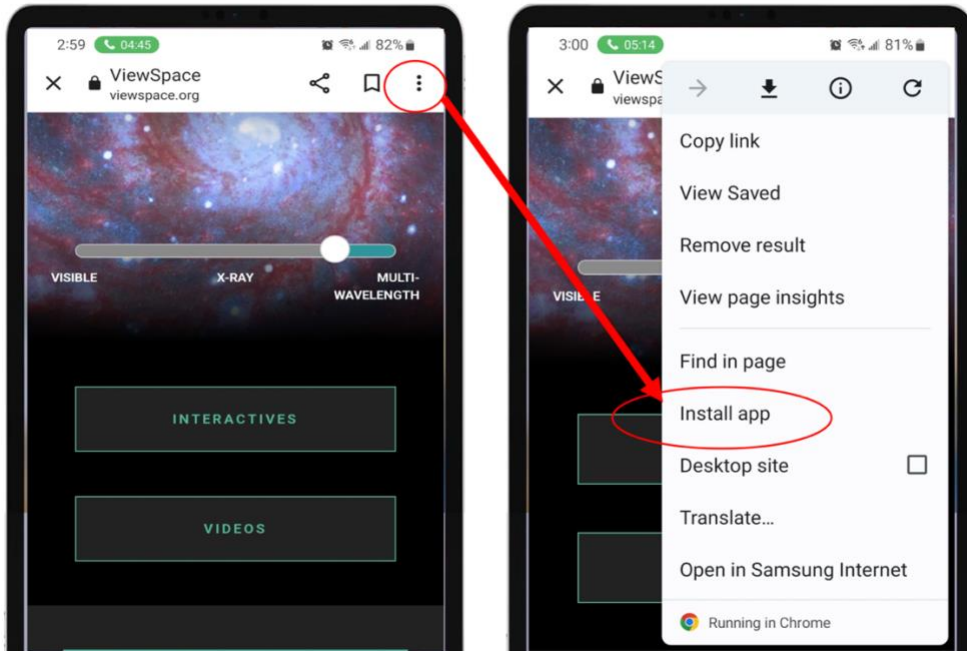

3. Click **Install**. A pop-up may appear that asks if you'd like to view the installed application.

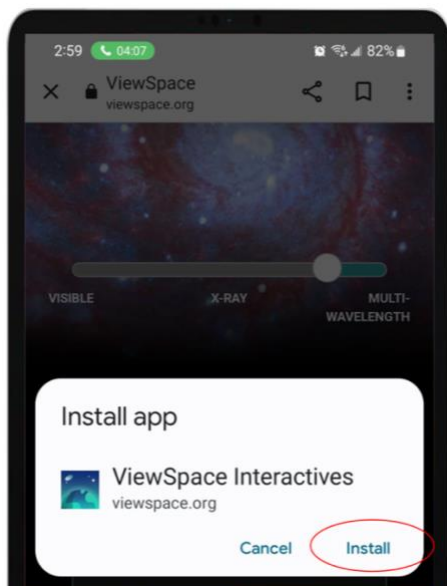

4. The ViewSpace Web App icon should now appear on your home screen.

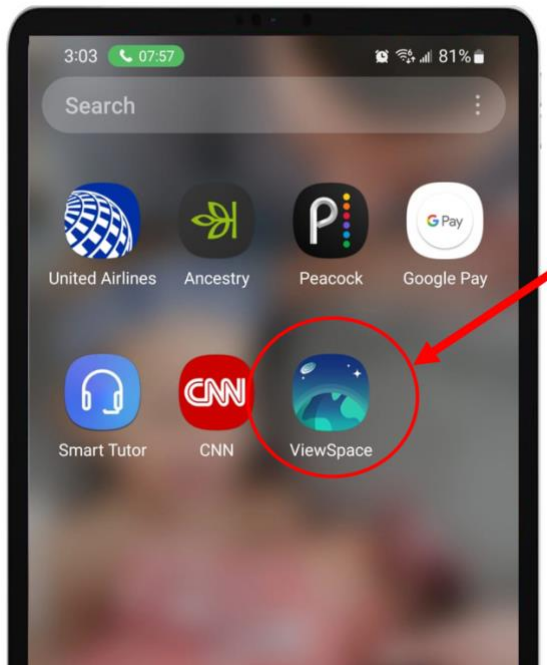

### Securing the Web App on an Android Mobile Device

If you'd like to set up an Android mobile device for use during public programs or as an interactive kiosk, follow these instructions to pin the app so users can't navigate away from the ViewSpace Interactives.

**Note:** "Pin windows" is Samsung Galaxy Tab S8's version of Guided Access. Other manufacturers may have their own built-in version or may allow you to download third party applications that fulfil the same function.

1. To enable "Pin windows," first open **Settings**, and then click on the section called **Biometrics and security**.

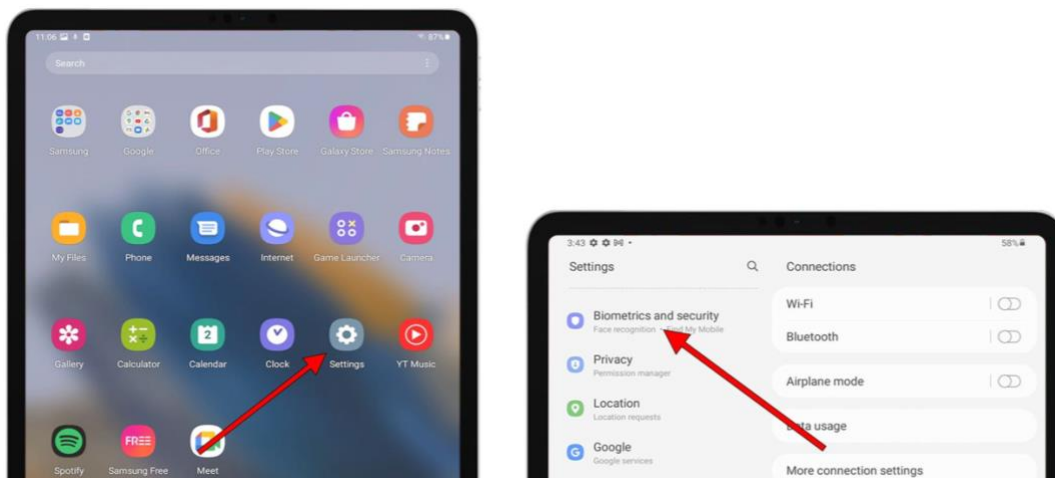

2. Click on **Other security settings** to access the second-level settings.

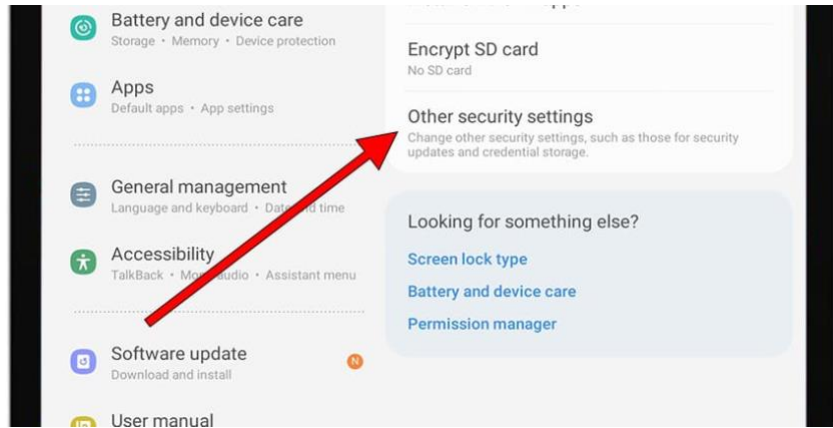

3. Scroll down until you find the **Pin windows** section, and click on the toggle to activate. Then, click on the text to define its additional settings.

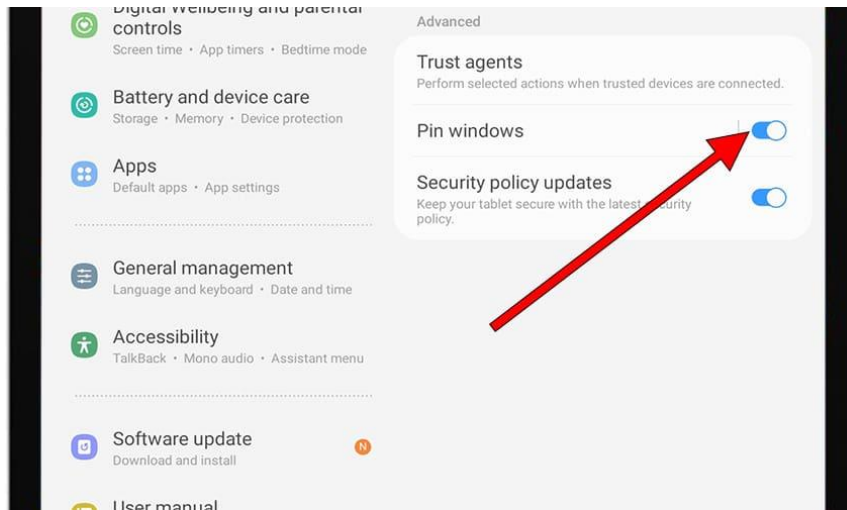

4. Follow the instructions to **create a PIN or Password** (if you don't have one already) to secure your device while displaying a pinned application.
5. Turn on the **Ask for PIN before unpinning** toggle to ensure that users cannot navigate away from the Web App once it has been pinned.

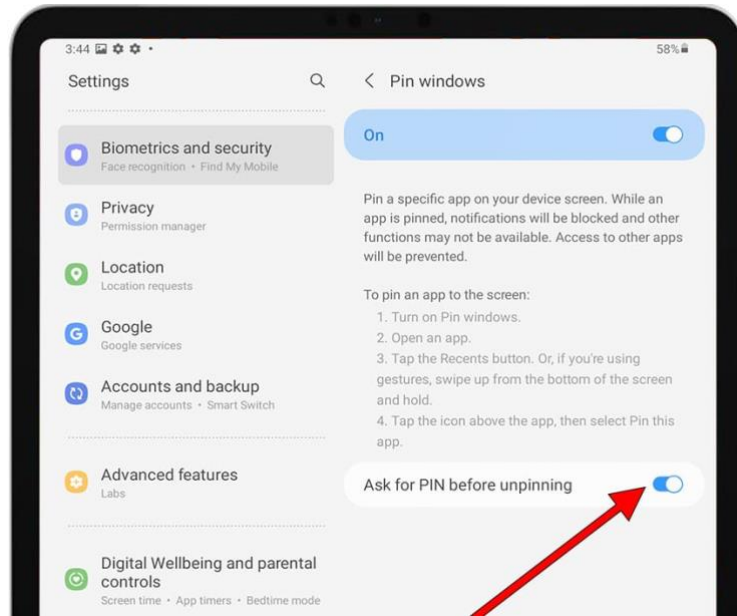

6. Using the navigation bar at the bottom of your home screen, click on the **Recents** button (resembles three vertical tally marks) to open your recently opened apps. From there, click on the ViewSpace Web App icon to display the drop-down menu of options.

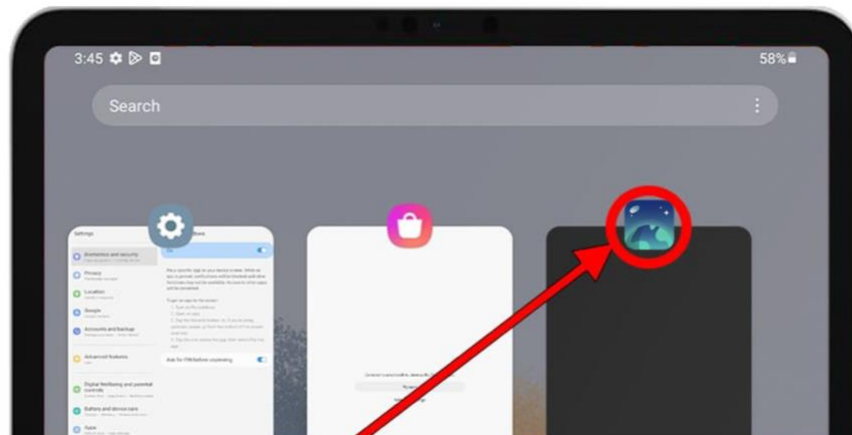
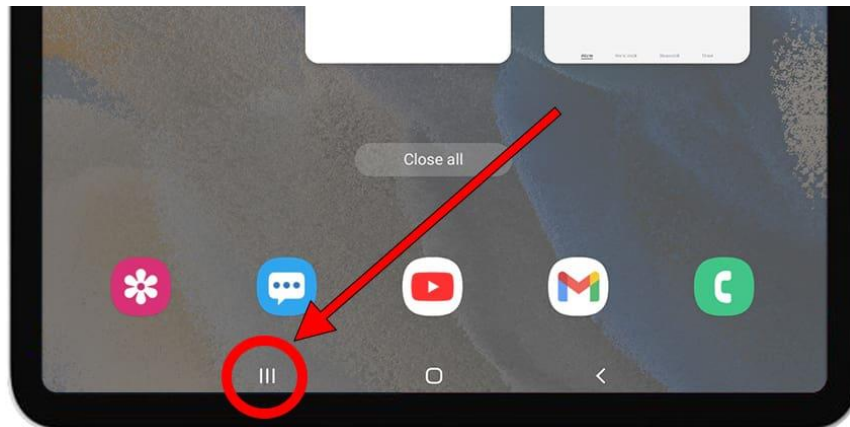

7. Select **Pin this app** from the drop-down menu. This will now pin the application or window on the Samsung tablet's screen.

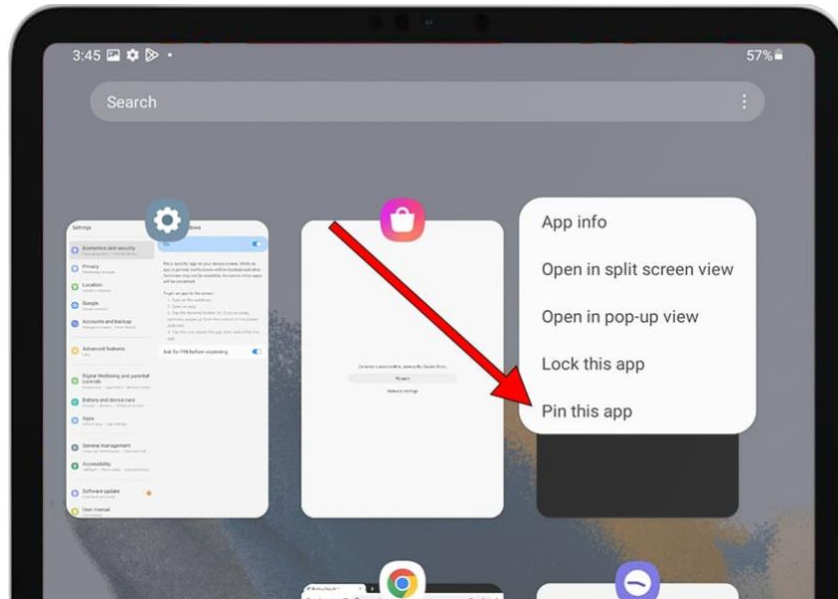

8. With the Web App pinned on the screen, now those using the Samsung tablet will not be able to exit the interactives without knowing the unlock code or pattern that you have defined.
9. **To deactivate or stop pinning the Web App:** Press and hold the **back** (shown as an arrow pointing left) and **recent applications button** (shown as three vertical bars) at the same time (as shown in the image below).

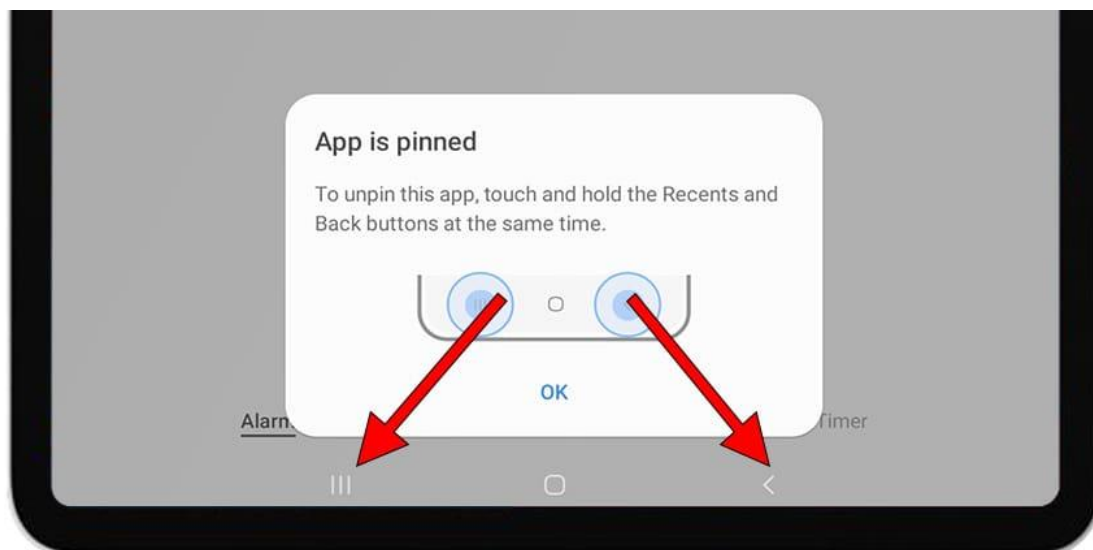

## Support and Contact Information

If you have trouble following any part of this document, cannot find answers to your questions within it, or wish to provide feedback, you can contact us directly at: [support@viewspace.org](mailto:support@viewspace.org).